

Century



rear seat manual

Please read it carefully before using.

Keep the instruction manual in your car.

TABLE OF
CONTENTSContents

1	Rear door, rear door glass	The opening and closing operation of the door and door glass, and cautions are explained.
2	rear seats	There are instructions on how to use the rear seat comfortably.
3	How to use the interior equipment	Explanations are provided for comfortable use of the in-room equipment. (How to turn on the room lights, how to use the room equipment, etc.)
4	How to care	It explains how to care for and maintain your vehicle.
5	Customize	It contains information on vehicle specifications and customization features.
	Sakuin	You can search for information in this manual using methods such as alphabetical order.

Please also read the separate "Century Instruction Manual" and "Electro Multivision Instruction Manual".

TABLE OF CONTENTSContents

1 Rear door,
rear door glass

1-1. How to open/close and lock the door

Unlocking/locking the rear door 14

Opening and closing the rear door..... 16

1-2. How to open and close the door glass....

Opening and Closing the Rear Door Glass 19

2 rear seats

2-1. How to adjust the seat

Adjusting the rear seats 22

Seat position memorization and recall function .. 24

Door open interlocking return operation function .. 26

Rear seat Operation of the front passenger seat from the Footrest 30

Ottoman function 31

Heated seats 34

Comfortable Air Seats 36

Refresh seat (seat with vibrator).. 38

Armrest..... 40

Rear seat belt.. 42

2-2. For safe use

Correct riding posture..... 46

SRS airbags.....47

3How to use the interior equipment

3-1. How to use air conditioner defogger

Operating the front air conditioner from the rear seat 56

Operation of the rear air conditioner with air purifier (air purifier) 58

negative ion About the generator 62

3-2. How to use audio

Audio63

Listening to the radio..... 65

Listening to cassette tapes 67

Listening to CDs 69

3-3. How to turn on the interior light

List of Interior Lights 74

3-4. How to use storage equipment

List of storage equipment 77

3-5. How to use other interior equipment

Vanity Mirrors..... 82

Clocks..... 83

Signboards..... 84

Ashtray 85

Cigarette Lighter 86

Accessory Socket 87

Retractable coat hook 88

Shoehorn holder 89

4H	to care
----	---------

4-1. How to care

Upholstery care	92
-----------------------	----

5	Customize
---	-----------

5-1 Customization function

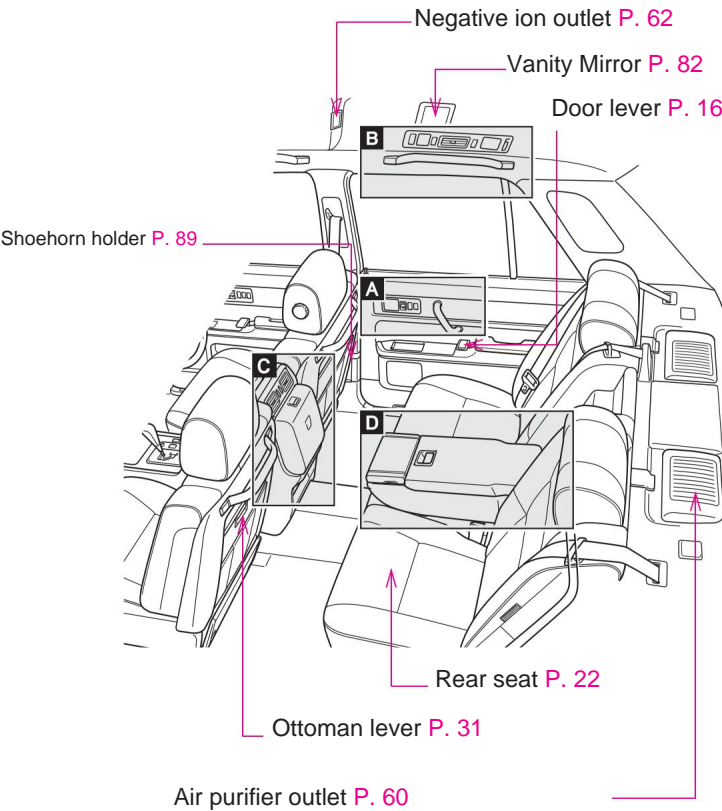
Customization function list	96
-----------------------------------	----

	Sakuin
--	--------

Japanese syllabary order.....	98
-------------------------------	----

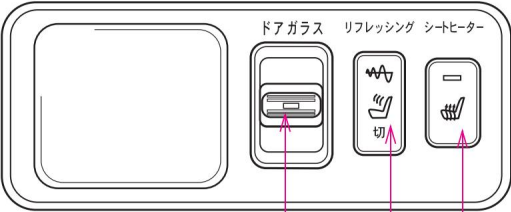


Illustration table of contents Around the back seat



BTO00BN001

A.



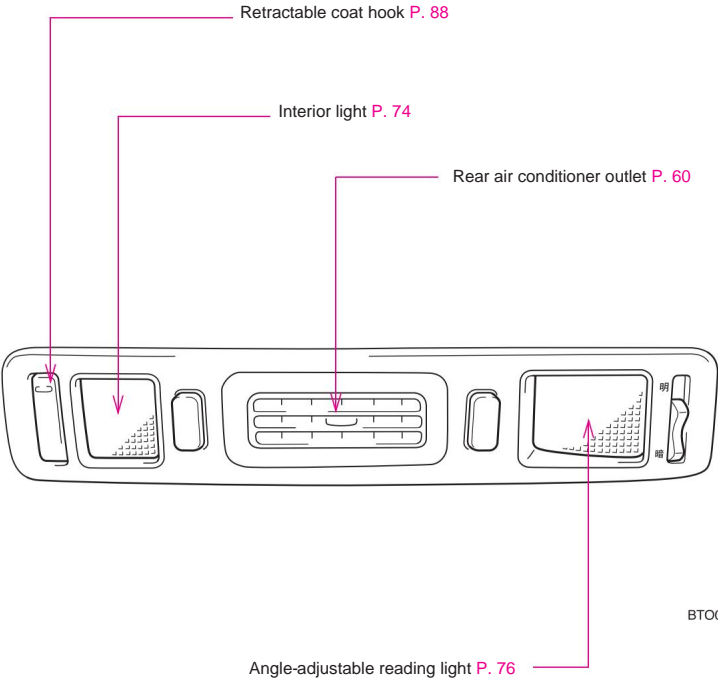
Door Glass Open/Close Switch P. 19

Refresh sheet switch P. 38

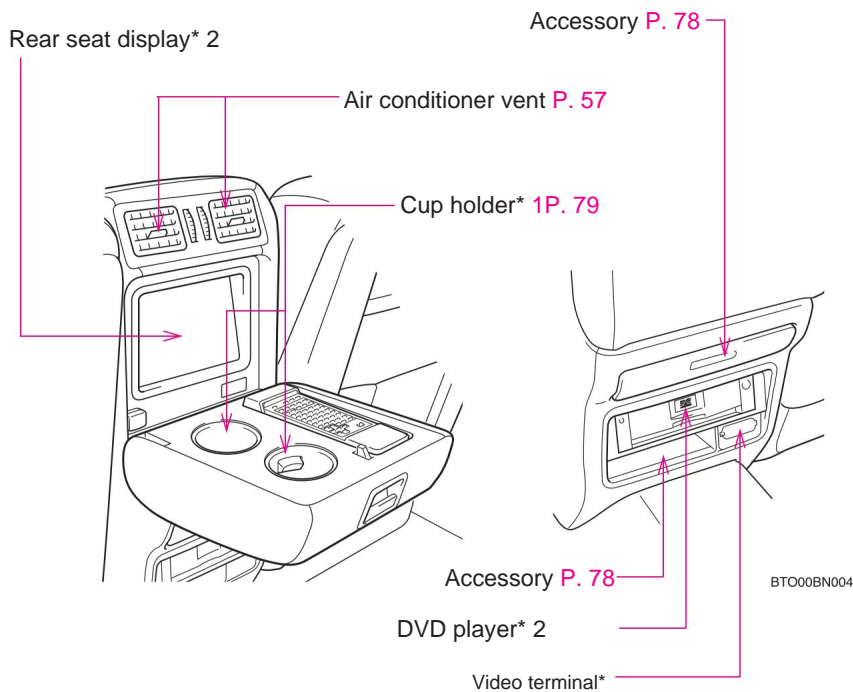
Seat heater switch P. 34

BTO00BN002

B.



C.

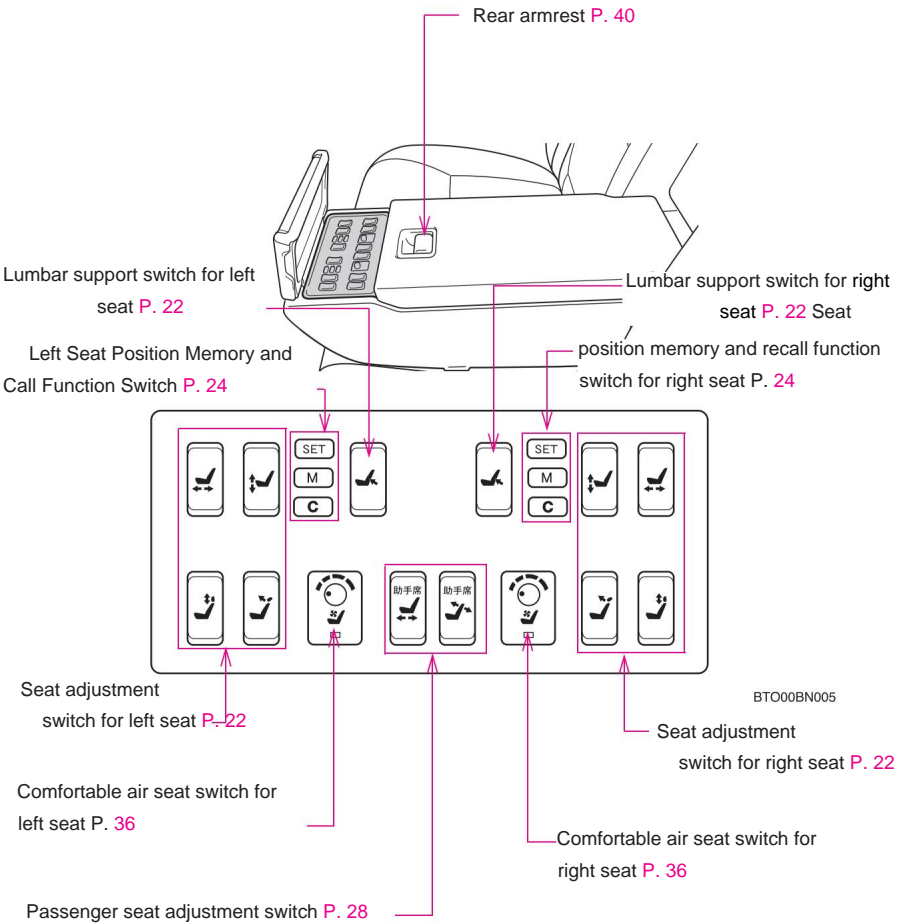


* 1: The cup holder may be installed in the rear center armrest depending on the specifications.
(Please refer to P. 9 when installing in the rear center armrest.)

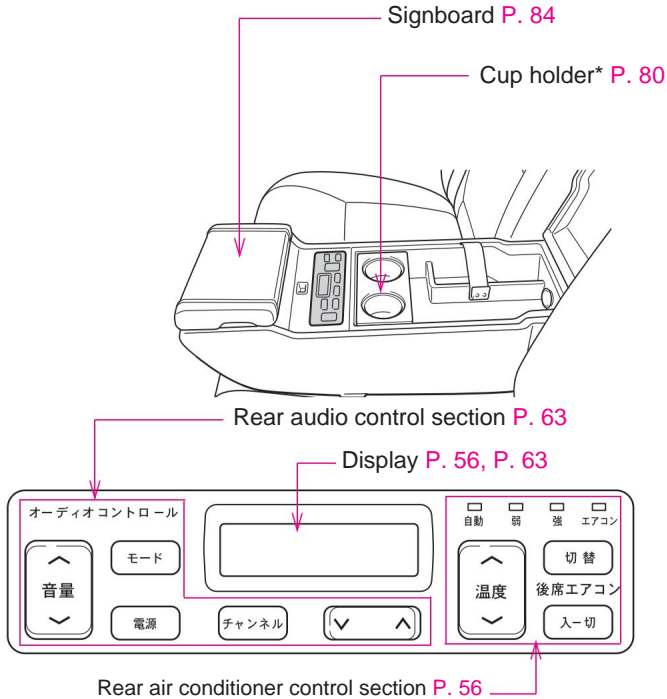
* 2: Refer to the separate "Electro Multivision Instruction Manual".

Illustration table of contents Around the back seat

D.



D.



BTO00BN006

*: The cup holder may be installed in the rear console tower depending on the specifications. (Please refer to P.7 if it is installed in the rear console tower.)

What you need to know

About the contents of this manual

This manual describes all equipment including options. Therefore, there may be descriptions of equipment that your vehicle does not have. Also, please note that the contents may not match the vehicle due to changes in vehicle specifications. For the handling of equipment installed at a Toyota dealer (dealer option), please read the instruction manual attached to the product.

Illustrations may not match the equipment of your vehicle due to differences in specifications, etc.

About unauthorized modification

- Installing parts other than those that Toyota has notified the Ministry of Land, Infrastructure, Transport and Tourism may constitute unauthorized modification.
- Lowering the vehicle height or installing parts that are not suitable for the vehicle's performance and functions, such as installing wide tires, may cause a malfunction, cause an accident, and may result in serious injury.
- Never modify the handle. The steering wheel contains an SRS airbag that, if handled improperly, may malfunction or inflate accidentally, resulting in serious injury or even death.
- In the following cases, please consult your Toyota dealer.
 - Replacement of tires, disc wheels, and wheel mounting nuts.
Using a different type or something other than specified may adversely affect driving or result in unauthorized modification.
 - Installation and removal of electrical equipment, wireless devices, etc.
It is dangerous as it may adversely affect electronic equipment parts and lead to accidents such as malfunction and vehicle fire.
- Do not attach colored films (including transparent films) to the windshield and window glass of the driver's seat and passenger's seat. Not only does it block your view, but it may also lead to unauthorized modification.

Notes on driving

Always pay attention to your surroundings, such as other vehicles and pedestrians, and drive safely.

Never drink and drive. If you drink alcohol, your attention and judgment will be dulled, which may lead to an unexpected accident. Also, avoid driving if you have taken drugs that make you drowsy. Do not use mobile phones or adjust devices while driving. It is very dangerous because you will not pay enough attention to your surroundings. The use of non-hands-free car phones and mobile phones while driving is prohibited by law.

When carrying a child


Never leave your child unattended in the car. The inside of the car becomes hot and can lead to heatstroke, dehydration, and in the worst case, death. It is also dangerous for children to operate the devices inside the car, get caught in the door glass, get burned by lighters, flares, etc., or move the driving device, which may lead to an unexpected accident. Please read the separate "Century Owner's Manual" for instructions on how to ensure the safety of children and how to install a child seat, etc.

About warranty and inspection


The warranty and inspection and maintenance are described in the separate "Maintenance Note", so please read it together. It is the customer's responsibility to carry out daily and periodic inspections and maintenance. (required by law)

About indications in this manual


WARNING, CAUTION, AND KNOWLEDGE

 warning

Failure to observe the items described here may result in danger to life or serious injury. Please read carefully to avoid or reduce danger to yourself and those around you.


 caution

Failure to observe the items described here may result in malfunction or damage to the vehicle or its accessories, or may not ensure correct performance.

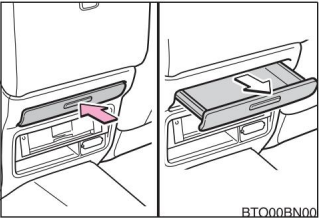
 knowledge

Explains things other than explanations of functions and operation methods that you should know and things that are useful to know.

About the display in the illustration



The safety symbol means “Don’t do this”, “Don’t do this”, “Don’t let this happen”.



Action arrow

- ➡ Indicates the operation of a switch, etc. (pressing, turning, etc.).
- ➡ Indicates an action after an operation (such as opening the lid).

BTO00BN00

Rear door/rear door glass 1

1-1. How to open/close and lock the door

Unlocking/Locking the Rear Doors 14

Opening and Closing the Rear Doors 16

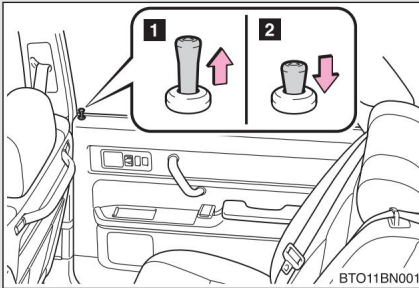
1-2. How to open and close the door glass

Opening and Closing the Rear Door Glass19

1-1. How to open/close and lock the door

Unlocking/locking the rear door

You can unlock or lock the rear doors with the door lock button.



1 Unlock

2 locking

When locking the rear door from the outside without using the key

With the door open, move the door lock button to the lock side and close the door.



knowledge

• Vehicle speed sensitive auto door lock

All doors are automatically locked when the vehicle speed exceeds approximately 20 km/h.

• Impact sensing door unlock system

All doors are unlocked when the vehicle receives a strong impact from the front, rear, left, or right. It may not work depending on the degree of impact or the type of accident.

• Functions that can be set at the store

You can change the setting of the vehicle speed sensitive automatic door

lock. (List of customization functions P. 96)



warning

• To prevent accidents

Be sure to observe the following while riding. Failure to do so may result in the door opening unexpectedly, resulting in serious injury or even death.

- Always use a seat belt
- Lock all doors

Close all doors securely

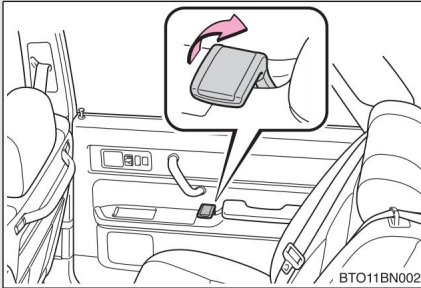
Do not pull the door lever on the inside of the door while driving.

The door may open and you may be thrown out of the vehicle, causing serious injury or, in the worst case, death.

It may lead to death.

1-1. How to open and close the door, how to lock the rear door

When the rear doors are unlocked, the door levers can be used to open and close the rear doors.



pull up the lever



knowledge

• Rear door closer

When the door is ajar, the rear door closer operates and the door automatically closes completely.

- The rear door closer will not operate regardless of the state of the engine switch.

vinegar.

- When the door is closed while the door lever inside or outside the vehicle is pulled, the rear door claw the user does not work.

- Even when the rear door closer is operating, the door can be opened by pulling the door lever inside or outside the vehicle. (Except when the door lock button is on the lock side)

- Motor noise can be heard for a few seconds after the door closes on the rear door closer
However, this is not an anomaly.



warning

• To prevent accidents

Please observe the following while riding.

Failure to do so could result in the door opening unexpectedly, resulting in serious injury or even death.

- Always use a seat belt

- Lock all doors

Close all doors securely

Do not pull the door lever on the inside of the door while driving.

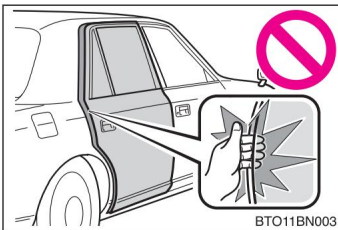
The door may open and you may be thrown out of the vehicle, causing serious injury or, in the worst case, death.

It may lead to death.

• When opening and closing the door

Check the surrounding conditions such as slopes, narrow spaces between the door and wall, strong winds, etc., and hold the door lever firmly to open and close the door so that you can handle unexpected movements.

• About the rear door closer



- When the door is ajar, the rear door closer will operate and close automatically, so be careful not to get your fingers caught. It is dangerous as it may cause serious injury such as broken bones.
- It takes a few seconds for the rear door closer to operate after the door is ajar. Do not get your fingers caught in the opening of the door. It is dangerous as there is a risk of serious injury such as bone fracture.
- Be especially careful when the door lock button is on the locking side, as the operation of the rear door closer cannot be stopped.



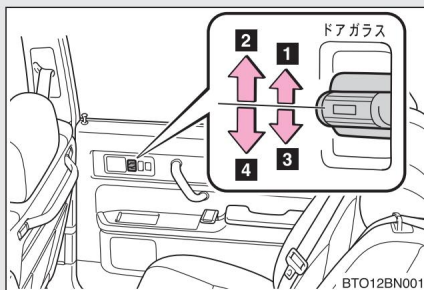
caution

• To prevent damage to the rear door closer

Do not open and close the door frequently or apply excessive force to the door while the rear door closer is operating.

1-2. How to open and close the **door glass****Opening and closing the rear door glass**

Door glass can be opened and closed with a switch.



- 1** Close
- 2** Automatic full-close* (strongly raise)
- 3** Automatic
- 4** full -open * (strongly lower)

* To stop in the middle, operate the switch to the opposite side.



knowledge

ÿ Operating conditions

When the engine switch is "ON"

ÿ Pinch prevention function

If a foreign object gets caught between the window frame and the door glass while the door glass is closed, the operation will stop and the door will open slightly.

ÿ Window lock switch

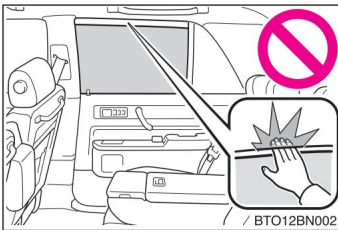
When the driver's seat window lock switch is locked, the rear door glass cannot be opened or closed with the rear seat switch. For the window lock switch, see the separate "Century Instruction Manual".



warning

• When opening and closing the door glass

Be sure to observe the following. Failure to do so may result in serious injury or, in the worst case, death.



- When opening and closing the door glass, be careful not to get your hand, arm, head or neck caught or caught. In particular, please tell children not to put their hands out.

- Do not allow children to operate the door glass. Serious injury or, in the worst case, death, may result from being caught or caught in the door glass.

• Pinch prevention function

- Do not pinch the hands, arms, head, neck, etc. of the occupant as this will intentionally activate the anti-pinch function. Serious injury or, in the worst case, death may result.

- The anti-pinch function may not work if a foreign object is caught just before the door glass is completely closed. Also, the anti-pinch function will not work if the switch is held up. Be careful not to pinch your fingers, etc. It is dangerous and may cause serious injury.



caution

• When opening and closing the door glass

Please observe the following.

- Do not move the driver's seat switch and other door switches in opposite directions at the same time.

Do not keep pressing the switch in the same direction after the door glass is fully opened or closed.

rear seat 2

2-1. How to adjust the seat Adjusting

the rear seat	22
Seat position memory and recall function.....	24
Door opening-linked return operation function	26
Operation of front passenger seat from the rear seat	28
Footrest	30
Ottoman function	31
Heated seats	34
Comfortable Air Seats	36
Refresh seat (seat with vibrator) ..	38
Armrest	40
Rear seat belts.....	42

2-2. For safe use

Correct riding posture.....	46
SRS airbags.....	47

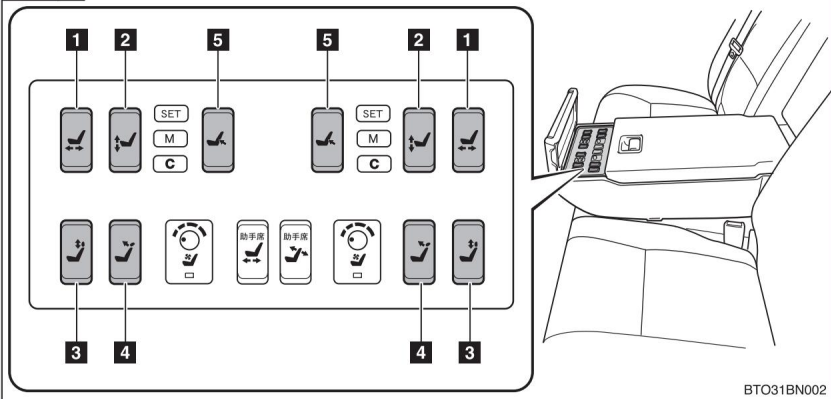
2-1. How to adjust the seat

Adjusting the rear seat

The rear seats can be adjusted electrically.

Step 1 Open the front lid of the rear center armrest (ý P. 40)

Step 2



1 Seat fore/aft adjustment

2 Seat cushion front height adjustment

3 Headrest up/down adjustment

4 Headrest forward/backward adjustment

5 Lumbar support (hardness of the backrest and lumbar region) adjustment

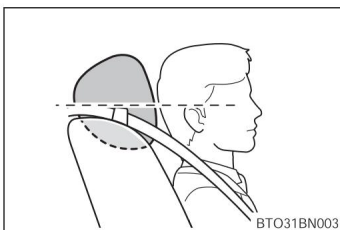


knowledge

Removing the rear headrest

Please consult your Toyota dealer about how to remove or install the headrest.

About the height of the headrest



Be sure to adjust the center of the headrest to the top of both ears.

2

リヤシート



warning

About the headrest

Please observe the following.

Failure to do so may result in serious injury or, in the worst case, death.

- Use a headrest that is dedicated to each seat.
- Adjust the headrest to the correct position.
- Do not drive with the headrest removed.

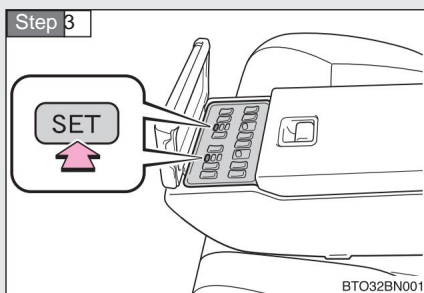
2-1. How to adjust the

seat Seat position memory and recall function

You can register your favorite seat position and call it with one touch.

☞ Position registration

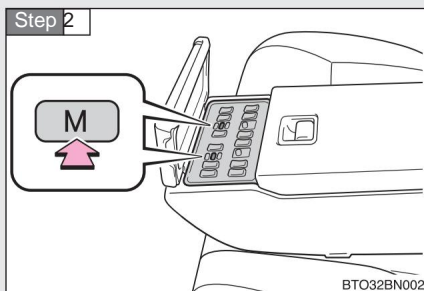
Step 1 Open the lid on the front side of the rear center armrest (☞ P. 40) .



Keep pressing the SET button until you hear a beep.

The seat position adjusted in step 2 is memorized.

☞ Calling a position



Press and hold the M button until you hear a beep.

The seat moves to the memorized seat position.



knowledge

ÿ Operating conditions

When the engine switch is "ON"

ÿ About calling positions

The left seat does not operate when the center backrest of the front passenger seat is tilted backward.

ÿ To stop the call operation of the position in the middle

Do one of the following:

- Press the SET button
- Press the M button
- Press the seat cushion front height adjustment button
- Press the seat forward/backward position adjustment button
- Press the C button (ÿ P. 27)

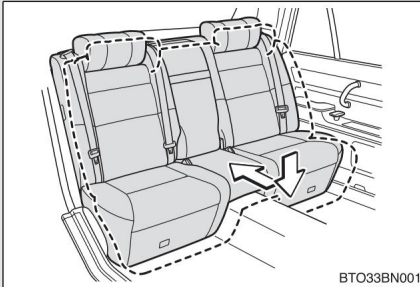
ÿ When the battery is removed

The memorized seat position is erased.

2-1. How to adjust the seat

Return operation function linked to door opening

When the rear doors are opened, even if the rear seats are adjusted to the forward position, they automatically move backwards, making it easier to get out of the vehicle.



When getting off: Rear seat moves backward

seat cushion is up

If so, the seat cushion will be lowered at the same time.

When boarding: The rear seat moves to its original position *.

*If you adjust the position of the rear seat to your preferred position, the position of the rear seat will be memorized.

If the door is closed again while the seat is being operated by the door opening interlocking return operation function, the operation will stop.
won't stop



knowledge

Operating conditions

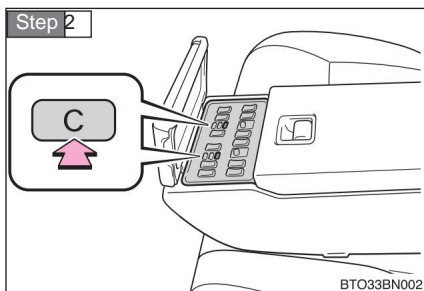
It can be activated when the following conditions are met:

- When the engine switch is "ON"
- When the shift lever is in P (or when the brake pedal is depressed and the vehicle is
tree)

When door open interlocking return operation is not required

You can disable the door opening interlocking return operation function in advance.

Step 1 Open the front lid of the rear center armrest (ÿ P. 40)

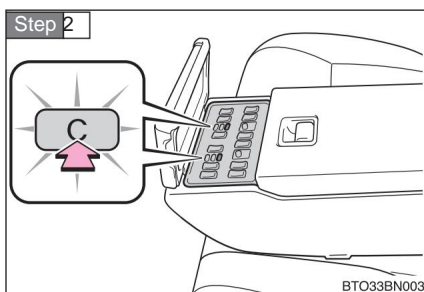


I press the button

The C portion of the button lights up.

ÿ To reactivate the door open interlocking return operation function

Step 1 Open the front lid of the rear center armrest (ÿ P. 40)



Press the button while the C part of the button is lit.

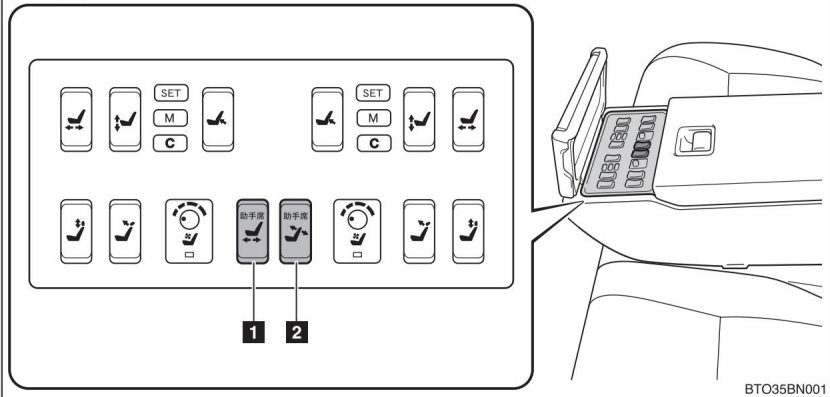
The C part of the button goes out.

2-1. How to adjust the **seat Operation****of the front passenger seat from the rear seat**

The front passenger seat can be adjusted electrically from the rear seat.

Step 1 Open the front lid of the rear center armrest (ý P. 40)

Step 2



BTO35BN001

1 Passenger seat front/rear position adjustment

2 Passenger seat recline adjustment



warning

ý Seat adjustment

- Be careful not to let the seat hit the occupants or luggage.
- Do not lower the backrest more than necessary.

In the event of an accident, your body may slip under the seatbelt and your abdomen may be strongly compressed, resulting in serious injury that can be life threatening.

ý About passenger seat operation from the rear seat

Do not operate when there is an occupant in the passenger seat. Also, do not sit on the front passenger seat during operation. Passenger seat occupant may get injured by pinching their leg.



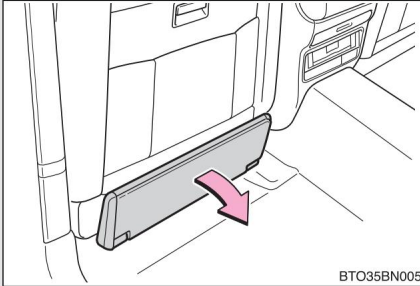
caution

⚠ About passenger seat operation from the driver's seat or the rear seat

Make sure there is nothing on the front passenger seat or under your feet to block the operation. Excessive force may be applied to the seat, causing it to malfunction.

2-1. How to adjust the seat **Footrest**

It enhances leg comfort for rear seat passengers.



Push it forward until it touches the floor



knowledge

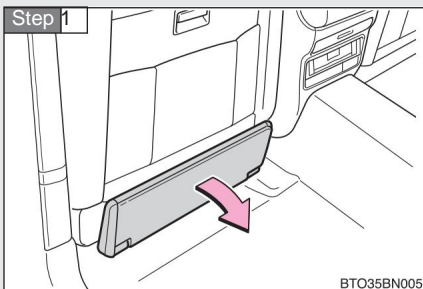
• About the angle of the footrest

The angle of the footrest can be adjusted by adjusting the height of the passenger seat cushion. For details, see the separate "Century Instruction Manual".

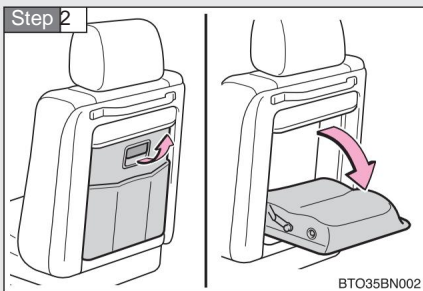
2-1. How to adjust the seat Ottoman function

You can adjust the backrest and headrest of the front passenger seat to your liking.

☞ Ottoman sheet



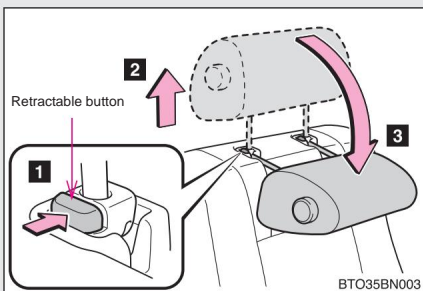
Fold the footrest forward until it touches the floor



Pull up the lever and fold the center of the backrest backward.

Adjust the rear seat and front passenger seat to your preferred position.

☞ Retractable headrest



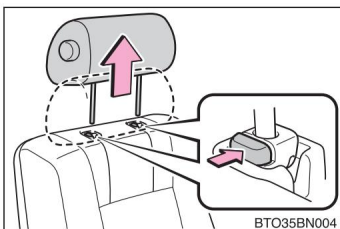
After pulling the headrest all the way up, press the folding button to pull it up further and fold the headrest forward.

2-1. How to adjust the seat



knowledge

Removing the foldable headrest



Pull up the headrest while pressing the buttons on both sides.

About the ottoman sheet

You can use the ottoman without folding the footrests, but the footrests may fall down.

About the retractable headrest

Depending on the seat position, the headrest may interfere with the vehicle ceiling, making it impossible to fold down. In that case, do not apply excessive force, such as lowering the seat vertical adjustment of the front passenger seat.



warning

About the retractable headrest

Do not let a person sit in the front passenger seat with the headrest folded down. This is dangerous as there is a risk of serious injury in the event of a collision. Always raise the head restraints and adjust them to the correct position before driving.

About the ottoman sheet

Be careful not to pinch your hands or feet when adjusting the rear seat and front passenger seat to your desired position.



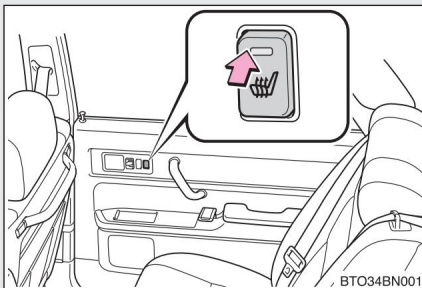
caution

⚠ About passenger seat operation from the driver's seat or the rear seat

Make sure there is nothing on the front passenger seat or under your feet to block the operation. Excessive force may be applied to the seat, causing it to malfunction.

2-1. How to adjust the seat seat heater

You can warm the seat.



press the top of the switch

When the seat heater is ON,
The indicator lights up. When the
seat warms up, it automatically turns to "weak"
Become.

Press the switch again to turn off
Become.

If the comfortable air seat (ÿ P. 36)
was activated, the comfortable air
seat is deactivated.



knowledge

ÿ Operating conditions

When the engine switch is "ON"

- Comfortable Air Seat (ÿ P. 36) cannot be used at the same time.
plug.

ÿ Operation from the front seat

You can also operate the rear seat heaters from the front seats. Please refer to the separate
"Century Owner's Manual" for operation from the front seat.



warning

• To prevent burns

- The following people should be especially careful as there is a risk of low-temperature burns.

• Infants, children, the elderly, the sick, and the physically handicapped
• Persons with sensitive skin
• Persons who are severely fatigued
• Persons who have taken heavy alcohol or drugs that induce drowsiness (sleeping pills, cold medicine, etc.)

- Do not use blankets or cushions on the seat.

Using a seat heater increases heat retention and may cause abnormal overheating.



caution

• To prevent seat heater failure

Do not place heavy objects with unevenness on the seat, or pierce the seat with sharp objects such as wires or needles.

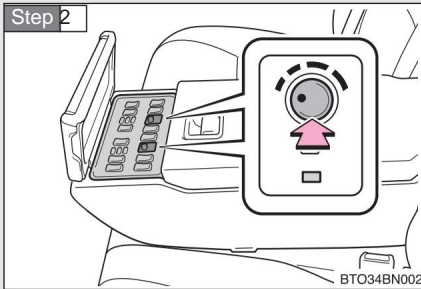
• To prevent dead battery

Do not use when engine is stopped.

2-1. How to adjust the seat Comfortable air seat

The sheet surface can be cooled.

Step 1 Open the front lid of the rear center armrest (ÿ P. 40)



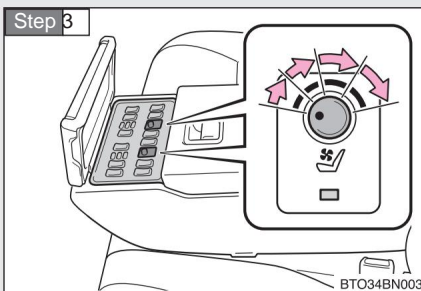
press the knob

comfortable air seat

When ON, the indicator is
lights up.

Press the switch again to turn off
Become.

If the seat heater (ÿ P. 34) was
operating, the seat heater will stop
working.



Rotate the knob to set the temperature

It can be adjusted in 4 steps.



knowledge

• Operating conditions

When the engine switch is "ON"

- Cannot be used together with the seat heater (• P. 34).

• Operation from the front seat

The comfortable air seats can also be switched on/off from the front seat. Please refer to the separate "Century Owner's Manual" for the operation from the front seat.

• Filters

The comfortable air seat contains a filter. Please consult your Toyota dealer for replacement. Replacement guideline: Every 15,000 km (but not more than 1 year)



warning

• To prevent overcooling

- Because there is a risk of overcooling, please be especially careful in the following cases.

• Infants, children, the elderly, the sick, and the physically handicapped • Persons with sensitive skin • Persons who are severely fatigued • Persons who have taken heavy alcohol or drugs that induce drowsiness (sleeping pills, cold medicine, etc.)



caution

• To prevent failure of comfortable air seats

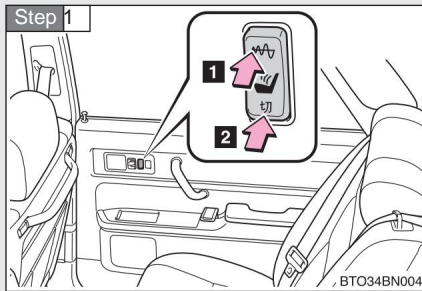
Do not place heavy objects with unevenness on the seat, or pierce the seat with sharp objects such as wires or needles.

• To prevent dead battery

Do not use when engine is stopped.

2-1. How to adjust the seat Refresh sheet (seat with vibrator)

It is a refreshing sheet that uses the operation of a vibrator.



press the top of the switch

Press the upper side of the switch to start operation

To do.

Press and hold the upper side of the switch
to change the vibration speed.

Pressing the bottom of the switch
"OFF" will stop the vibrator.



knowledge

Operating conditions

When the engine switch is "ON"

Automatic stop function

The vibrator will automatically stop about 30 minutes after starting.



warning

About use

- If you are pregnant, have just given birth, have a rash malignant tumor, or have a disease that requires rest (heart disease), be sure to consult your doctor before using this product.
- Children should not use this product.
- Do not use after eating or drinking, or for a long time.
- If you feel sick during use, stop using it immediately.
- Do not modify the vibrator or use it for other purposes. Equipment failure
Not only that, but you may also get injured.



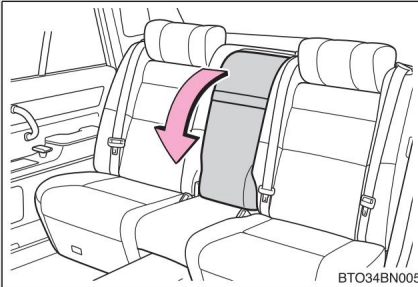
caution

• Troubleshooting

Stop using it immediately and have it inspected at your Toyota dealer.

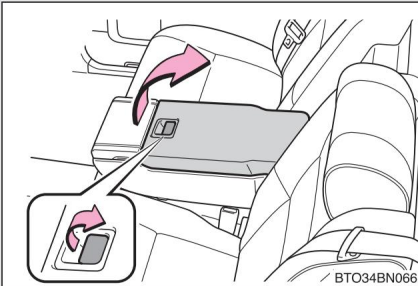
2-1. How to adjust the seat armrest

☞ To use



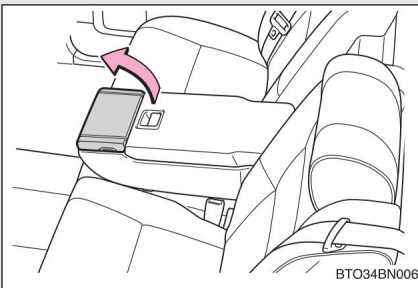
Knock it down to use it.

☞ To open the lid on the back side



Pull up the lever and raise the lid to the rear

☞ To open the front lid



lift the lid forward



caution

• To prevent damage to the armrest

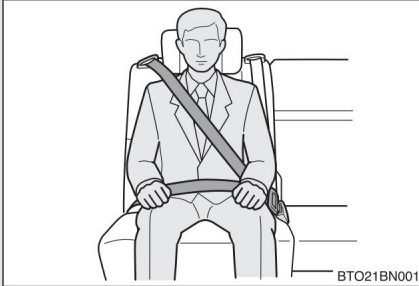
Do not apply excessive load.

2-1. How to adjust the seat Rear seat belt

All occupants must fasten their seat belts correctly before driving.

stomach.

How to wear it correctly



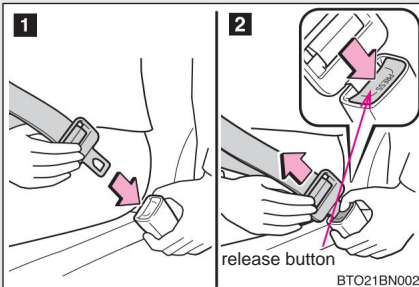
- Put the shoulder belt on your shoulders sufficiently.

Do not hang around your neck or come off your shoulders.

please do not

- Make sure the lumbar belt is attached to the lower part of the hipbone as much as possible.
- Adjust the backrest, raise the upper body, and sit down deeply.
- Avoid twisting

How to put on and take off



- 1 fixed

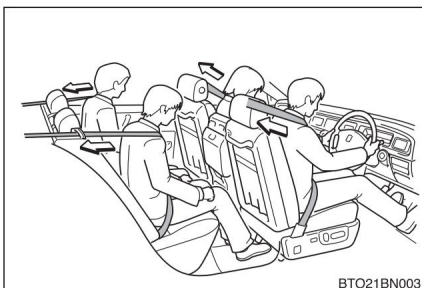
Insert until you hear a “click”

increase.

- 2 lift

Press the release button.

Seatbelt pretensioner (except center seat)



Appropriate occupant restraint effect is ensured by retracting the seat belt in the event of a strong frontal collision.

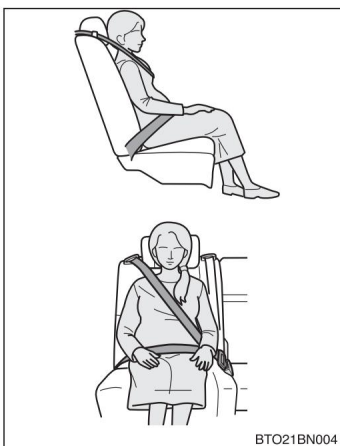
It may not work when the impact from the front is weak, or when the impact is from the side or back.



Emergency seat belt fixing mechanism

The belt is locked in the event of a sudden stop or impact. The seat may lock even if you suddenly lean forward or pull out the seat belt quickly. The belt can be pulled out by pulling the belt firmly, loosening it, and moving it slowly.

Pregnant women and those with medical conditions



Be sure to wear it correctly after confirming precautions with your doctor. (P. 42) Pregnant women should also wear the lumbar belt under the bulge of the abdomen in the same way as normal wearing so that it rests on the lower part of the hipbone as much as possible. Also, make sure that the shoulder belt passes over your shoulders, avoiding sagging of your stomach, and resting on your chest. If the belt is not worn correctly, in the event of a collision, not only the mother but also the fetus may be seriously injured, and in the worst case, it may lead to death.

ÿ How to use your child's seat belt

Car seat belts are designed for people who are large enough to wear a seat belt.

- For small children who cannot wear the seat belt in the correct position, please use a child seat* that fits the child's body.
- For children who can wear the seat belt in the correct position,
Please follow the wearing instructions. (P.42)

ÿ About the seat belt pretensioner

Seatbelt pretensioners only work once. Even if you are repeatedly hit by a pile-up collision, etc., once it is activated, it will not be activated in subsequent collisions.



warning

To avoid injury in the event of sudden braking or an accident, be sure to observe the following. Failure to do so may result in serious injury or, in the worst case, death.

ÿ Wearing seat belts

- Everyone wears a seatbelt when in a car

•Wear seat belts correctly

- Each seat belt should be used by one person

Do not use one belt for more than one person, even for children

Have your child sit in the rear seat and wear a seat belt.

Raise your upper body and sit deeply in the seat

Do not wear the shoulder belt under your arm

- Wear the lumbar belt in close contact with the lower part of the hipbone.

*: Refer to the separate "Century Instruction Manual".



warning

Regarding seat belt damage and failure

Do not damage belts, plates, buckles, etc. by pinching them between seats or doors.
Please be so.

- If the seat belt is damaged, do not use the seat until the seat belt is repaired.
please don't

- Check that the plate is securely inserted into the buckle and that the seat belt is not twisted. If you have trouble inserting it, contact your Toyota dealer immediately.

- In the event of a serious accident, even if there is no obvious damage,
Please replace the seat belt.

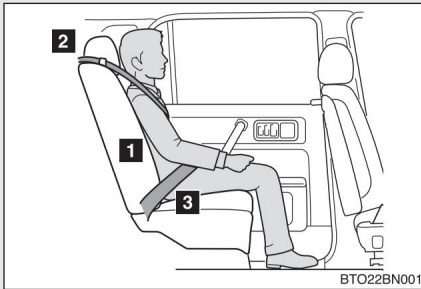
- Installation, removal, disassembly, disposal, etc. of seat belts with pretensioners
Do not do this at any place other than a Toyota
dealer. Improper handling may result in malfunction, serious injury or, in the worst
case, death.

Regarding seat belts with pretensioners

The SRS airbag/pretensioner warning light illuminates when the seat belt pretensioner is activated. In that case, the seat belt cannot be reused, so be sure to replace it at your Toyota dealer.

2-2. Correct riding posture for safe use

Ride in the correct posture that meets the following conditions.



- 1** Sit upright and keep your back from the backrest (P. 22)
- 2** The center of the headrest is behind your ears (P. 22)
- 3** You can wear your seat belt correctly (P. 42)



warning

• While driving

Do not insert cushions or other objects between the backrest and the back. In the event of a collision, the effects of seat belts and head restraints may not be fully demonstrated, which is dangerous.

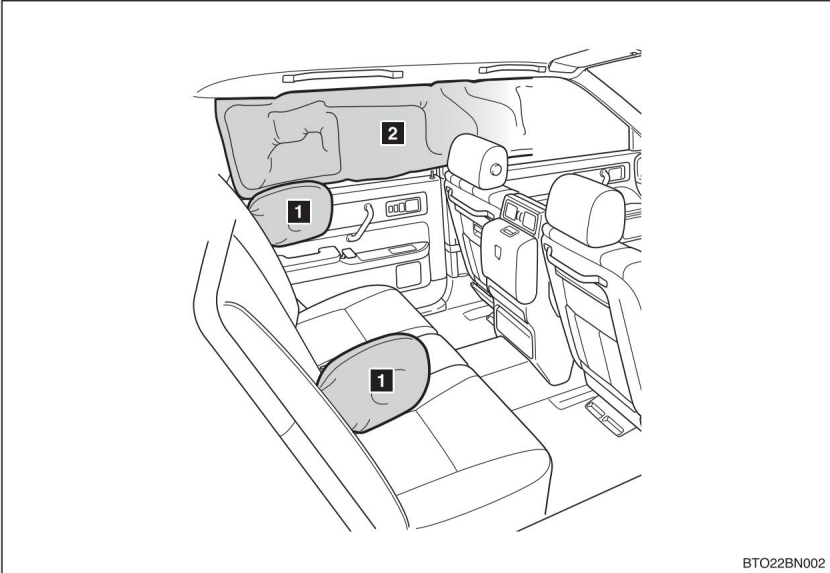
• When adjusting the seat

- Be careful not to injure the passenger by hitting the seat.
- Keep your hands away from under the seat or moving parts.

There is a danger of getting your fingers or hands pinched and getting injured.

2-2. SRS airbags for safe use

SRS airbags inflate when the occupant receives a strong impact that could cause serious injury, and the seat belt works to restrain the occupant's body, reducing the impact on the occupant.



BTO22BN002

- 1** SRS side airbags (mitigates the impact on the chest of rear outer seat occupants)
- 2** SRS Curtain Shield Airbag (Reduces impact mainly on the head of rear outer seat occupants)



knowledge

• When the SRS airbag deploys

- Contact with the SRS airbag may result in bruises or scratches.

vinegar.

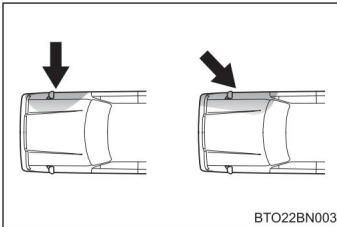
- White gas is generated along with the operating sound.
- Not only the rear seats, roof side rails, etc., but also each part of the airbag module (airbag cover, inflator) may become hot for several minutes. The airbag itself also heats up.

• When SRS airbags operate (SRS side airbags & SRS curtain side door airbag)

SRS side airbags and SRS curtain shield airbags have a set value for impact strength (equivalent to the impact strength when a vehicle weighing approximately 1.5 tons collides with the passenger compartment at a right angle at a speed of approximately 20 to 30 km/h). value) or higher.

When SRS airbags do not operate (SRS side airbags & SRS curtain shield airbag)

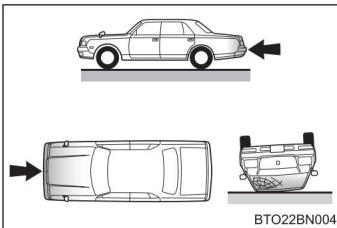
If you receive an impact from an angle, or if you receive an impact on the side other than the passenger compartment, SRS side airbags and SRS curtain shield airbags may not operate.



• Impact to the side other than the passenger compartment

Oblique impact

SRS side airbags and SRS curtain shield airbags are not designed to deploy in frontal or rear impacts, rollovers, or side impacts at low speeds.



• Collision from the front

• Collision from behind

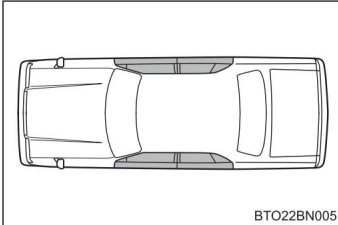
Overtake

2-2. For safe use

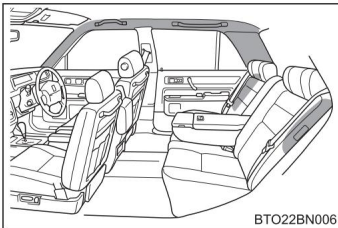
• If you need to contact a Toyota dealer

In the following cases, please contact your Toyota dealer as soon as possible.

• When one of the SRS airbags inflates



If the SRS side airbag/SRS curtain shield airbag did not inflate, but the door was hit in an accident, or if it was damaged or deformed.



When the surface of the seat with built-in SRS side airbag is scratched, cracked, or otherwise damaged

When the rear pillar part and roof side part where the SRS curtain shield airbag is built in are scratched, cracked, or otherwise damaged.



warning

• About SRS airbags

Be sure to observe the following.

Failure to do so may result in serious injury or, in the worst case, death.

- All drivers and passengers must wear seat belts correctly.

The SRS airbag is for assisting the seat belt.

- Since the passenger side SRS airbag also inflates with great force, it may lead to serious injury or, in the worst case, death. This is especially dangerous if the occupant is close to where the SRS airbag will inflate. Adjust the seat backrest so that the seat is as far away from the SRS airbag as possible and sit up straight.
- If the child does not sit firmly in the seat, the impact of the SRS airbag inflating may cause serious injury or, in the worst case, death. If your child is too small to use a seatbelt, secure him or her in a child restraint system. We recommend that you put your child in the back seat and use a child seat or seat belt. (Please see the separate "Century Instruction Manual")



Do not lean on the door, center pillar, rear pillar, or roof side rail.

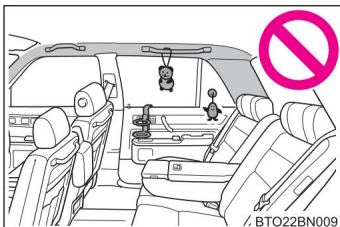


Do not kneel facing the door in the front passenger seat or rear outer seat, and do not put your face or hands out of the window.



warning

• About SRS airbags



Do not attach anything to the doors, windshield, door glass, front and rear pillars, roof side rails, assist grips, etc.

- Use a seat accessory that covers the area where the SRS side airbag inflates.
Do not use
- Do not hang a hard object such as a hanger on the coat hook.
Serious injury or death could result from being thrown when the SRS curtain shield airbag deploys.

Do not apply excessive force, such as hitting the area around the SRS airbag system components.
please don't

The SRS airbag may not operate normally.

Do not touch immediately after the SRS airbag is inflated as the component parts are hot.
please leave

- If you find it difficult to breathe after the SRS airbag has inflated, open the door or door glass to let air in, or confirm safety before exiting the vehicle. Wash off residue as soon as possible to prevent skin irritation.
- If the rear pillar part where the SRS airbag is stored or the roof side part is scratched or cracked, do not use it as it is and replace it at your Toyota dealer.



warning

⚠ About remodeling and disposal

Do not modify or dispose of the following without consulting your Toyota dealer.

If the SRS airbag does not work properly or inflates by mistake, it may lead to serious injury or, in the worst case, death.

•SRS airbag removal/installation/disassembly/repair

- Seat, seat upholstery, center pillar/rear pillar, roof side rail repair
repair, removal, modification

Modification of suspension

Installation of electrical appliances such as CD players and radios

How to use indoor equipment 3

3-1. How to use the air

conditioner/defogger Operating the front air	
conditioner from the rear	
seat	56
With air purifier (air	
purifier) Operation of	
the rear air conditioner	58
negative ion	
About generators.....	62

3-2. How to use audio

Audio	63
Listening to the radio	
65 Listening to cassette tapes	
67 Listening to CDs.....	69

3-3. How to turn on the interior

light List of interior lights	74
-------------------------------------	----

3-4. How to use storage equipment

List of storage equipment	77
---------------------------------	----

3-5. How to use other interior equipment

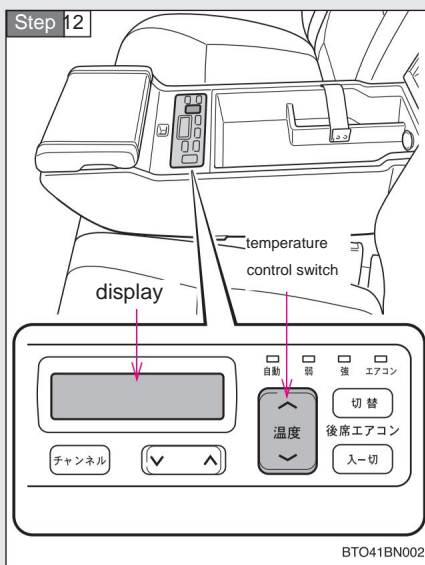
Vanity mirrors.....	82
Clocks.....	83
Signboards.....	84
Ashtray	85
Cigarette lighter	86
Accessory sockets	87
Retractable coat hook	88
Shoehorn holder	89

3-1. How to use the air conditioner/

defogger **Operating the front air conditioner from the rear seat**

The set temperature of the front air conditioner can be adjusted independently from the rear seat.

Step 1 Open the lid behind the rear center armrest (ÿ P. 40)



To change the temperature settings near the rear seat and front passenger seat

Press ÿ on the driver's seat to increase the set temperature, and press ÿ to decrease it.





knowledge

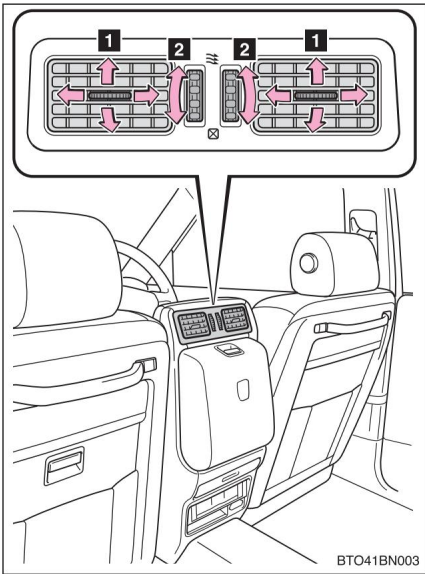
Operating conditions

When the front air conditioner is operating

About set temperature

- Independent adjustment of the front air conditioner can be performed from the driver's seat or from the passenger's seat. Please refer to the separate "Century Instruction Manual".
- If you adjust the temperature setting near the front passenger seat, the setting temperature near the driver's seat will not change, but the setting temperature for the rear seats will be the same as the temperature setting near the front passenger seat. Please refer to the separate "Century Instruction Manual".

Air direction adjustment and air outlet opening/closing



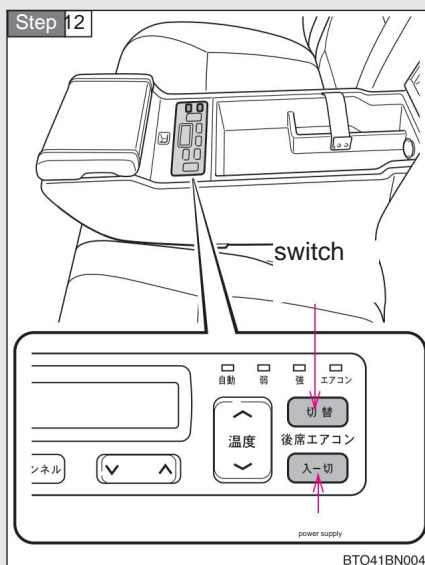
- 1 wind direction adjustment
- 2 Opening and closing the air outlet

3-1. How to use the air conditioner/

defogger **Operating the rear air conditioner with an air purifier**

A rear air conditioner with an air purifier is installed to cool the rear seats.

Step 1 Open the lid behind the rear center armrest (y P. 40)



To operate the rear air conditioner with air purifier

入-切 push

Every time you press the switch, the rear air conditioner with air purifier
Switches between ON and OFF.

To switch the operating state of the rear air conditioner with air purifier

切替 push

Each time the switch is pressed, the operation of the rear air conditioner with air purifier switches.

When the air conditioner switch of the front air conditioner is ON

切替 Each time is pressed, "Auto -> Low -> Low , A/C -> High, A/C -> Auto

The mode switches in the order of .

	Rear air conditioner Air purifier Air volume		
automatic	automatic adjustment		
weak	Stop	actuation	weak
weak , air conditioner	actuation		
strength , air conditioner			

When the air conditioner switch of the front air conditioner is OFF

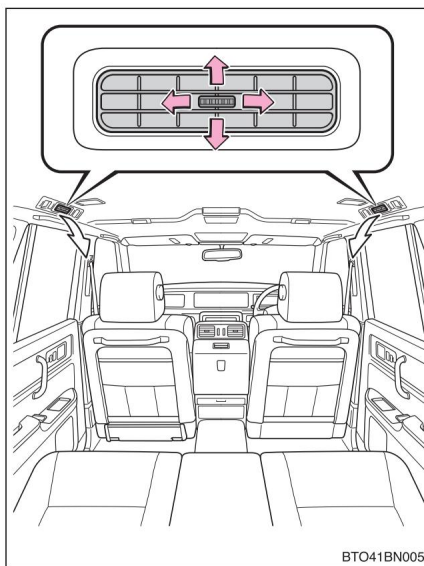
切替 Each time is pressed, the mode switches in the order of "Auto -> Low -> Strong -> Auto".

I will.

	Rear air conditioner Air purifier Air volume		
automatic	Stop	actuation	automatic adjustment
weak			weak
strength			strength

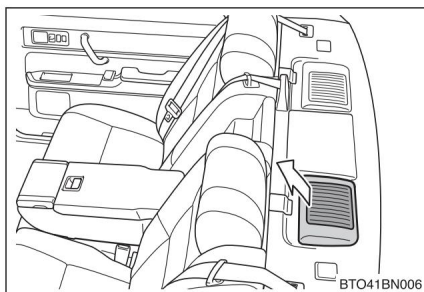
3-1. How to use air conditioner defogger

wind direction adjustment



Adjust by moving the knob or outlet body

air purifier outlet



knowledge

ÿ Filters

A filter is attached to the air purifier. Please consult your Toyota dealer for replacement. Replacement guideline: Every 15,000 km (but not more than 1 year)



caution

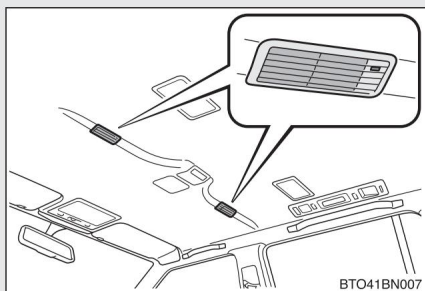
• To prevent failure

Always use the air purifier with the filter attached. Using the air purifier without a filter may cause malfunction.

3-1. How to use the air conditioner/

defogger About the negative ion generator

A negative ion generator is installed to reform the air inside the car and improve comfort. The negative ion generator is operated from the front seat. Please refer to the separate "Century Instruction Manual" for operation.



The activation indicator light for activated vents will illuminate.



knowledge

• Operation indicator light

When the negative ion generator is activated, lighting of the operation indicator light on the air outlet may be delayed, but this is not a malfunction.



warning

• About negative ion generator

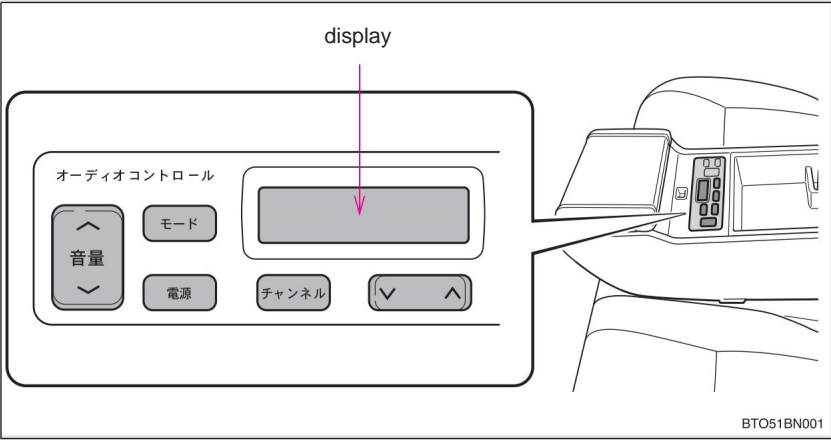
- The negative ion generator uses high voltage. It is dangerous, so be sure to consult your Toyota dealer for repairs.
- Do not spray or insert foreign objects such as sticks near the air outlet.

Please give me. Failure to do so may cause malfunction or electric shock.

3-2. How to use audioAudio

For DVD player and TV operations, refer to the separate “Electronic Multi-Vision Instruction Manual”.

Please refer to the separate "Century Owner's Manual" for audio operations in the front seats. The rear audio controls are located when you open the lid behind the rear center armrest (ÿ P. 40).



title	Reference page
listen to the radio	P.65
Listen to the front seat audio cassette tape	P.67
listen to a CD	P.69
for comfortable listening	See the separate "Century Instruction Manual"

3-2. How to use audio



knowledge

ÿ Use of mobile phones

If you use your mobile phone in or near your car while listening to audio, you may sometimes hear noise coming from the audio speakers.



caution

ÿ To prevent dead battery

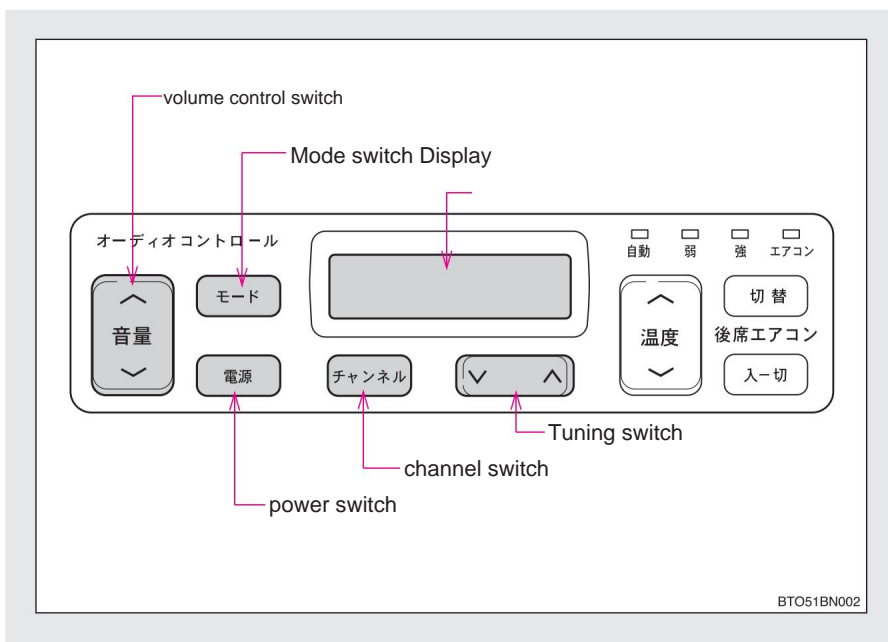
Do not use audio for long periods while the engine is off.

ÿ Handling of audio

Be careful not to spill anything such as a drink on the audio.

3-2. How to use audio

Listening to the radio



To adjust the volume



Press (Higher) or (Lower) of to adjust to your preferred volume.

To switch modes

Step 1

電源

to turn on the power.

To turn it off, press the switch again.

Step 2

モード

Press to select a radio broadcast band

Each time you press the switch, it switches as follows.

FM tape CD autochanger DVD player* ÿ TV* ÿ AM ÿ SW (short wave) ÿ FM

* For DVD player and TV operations, refer to the separate volume "Elect
"Roman Multi-Vision Instruction Manual".

Select a broadcasting station

• Select a station



Press (higher frequency) or (lower frequency) to

Find your favorite station

Press until you hear a beep to automatically select a receivable frequency.

• Press if the station is stored in advance in the front seat.



Each time you press the switch, the stored station changes.



knowledge

• About mode switching

Tapes, CD autochangers, and DVD players cannot be skipped and selected when not enabled.

• When the connection with the battery is cut off

Memorized stations are deleted.

• Receiving sensitivity

• Since the position of the antenna changes from time to time, the strength of the radio waves may change, and it may be difficult to maintain good reception due to the effects of obstacles, trains, traffic lights, etc.

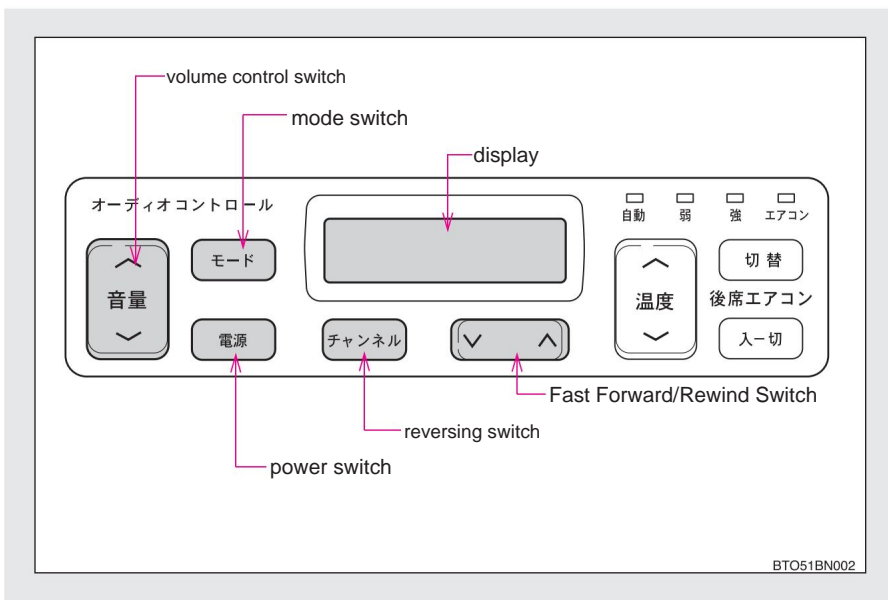
• The radio antenna is embedded in the rear glass.

• SW (short wave) band

The SW (short wave) band has preset stations.

3-2. How to use audio

Listening to cassette tapes



To adjust the volume



Press (Higher) or (lower) of to adjust to your preferred volume.

To switch modes

Step 1

電源 to turn on the power.

To turn it off, press the switch again.

Step 2

モード to select tape mode

Each time you press the switch, it switches as follows.

FM tape CD autochanger DVD player* ÷ TV* ÷ AM ÷ SW (short wave) ÷ FM

If tape mode is not selected, make sure you have a tape in your car's audio.

* For operation of the DVD player and TV, refer to the separate volume "Electro Multi-Vision

Please see the instruction manual.

fast forward/rewind



Press (Fast Forward) or (Rewind) of

To cancel, press the switch again.

Switching the playback side of the tape



push

The playback side will switch from side A to side B or from side B to side A.



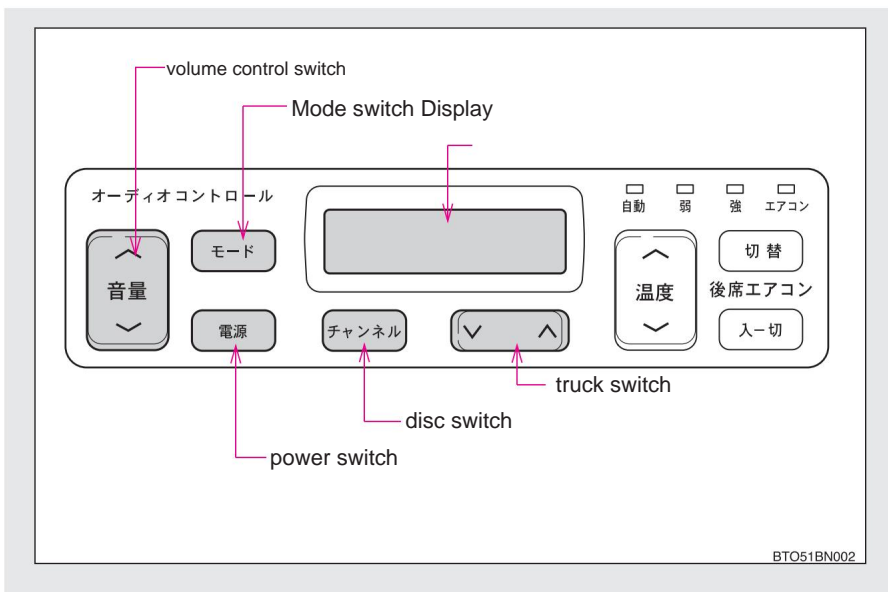
knowledge

ÿ About mode switching

Tapes, CD autochangers, and DVD players are skipped and cannot be selected unless they are enabled.

3-2. How to use audio

Listening to CDs



To adjust the volume



Press (Higher) or (Lower) of to adjust to your preferred volume.

To switch modes

Step 1



to turn on the power.

To turn it off, press the switch again.

Step 2



to select the CD autochanger mode

Each time the switch is pressed, it switches as follows.

FM tape CD autochanger DVD player* ÷ TV* ÷ AM ÷ SW (short wave) ÷ FM

If the CD autochanger mode is not selected, make sure there is a CD in the CD autochanger.

* For operation of the DVD player and TV, refer to the separate volume "Electro Multi-Vision

Please see the instruction manual.

Choose a CD

 push

Each press selects the next CD.

choose a song



Press (rear) or (previous) of to select the song you want to hear
do



knowledge

• About mode switching

Tapes, CD autochangers, and DVD players are skipped and cannot be selected unless they are enabled.

• Error display

- “CD ERR1”: The CD cannot be read because it is dirty.
- “NO DISC”: No CD is set in the magazine
- “CD ERR3”: CD autochanger error
- “CD ERR4”: CD autochanger error
- “WAIT”: Appears when the temperature of the CD autochanger is abnormal, and the function of the CD autochanger stops automatically. After a while, when the CD autochanger's temperature returns to normal, the display disappears and it becomes ready for use.

In addition to the above, in order to protect the inside of the CD autochanger, the function of the CD autochanger is automatically stopped when an abnormality occurs.

In this case, press the audio disc switch on the front seat side. If the function still stops, have it inspected by your Toyota dealer.

• Playable CDs

Discs with the following marks can be played. Playback may not be possible due to recording conditions, disc characteristics, scratches, dirt, or deterioration.



CDs with a copy protection function cannot be used.

• CD player protection function

In order to protect the inside of the player, playback will automatically stop if an abnormality occurs during use.

• Do not leave a CD inside the player or protruding from the player for a long time if left alone

Doing so may damage the CD and render it unusable.

• Lens cleaner

Do not use lens cleaner. Doing so may damage your player.



caution

• When using an 8cm CD

A genuine Toyota 8cm CD tray is required.

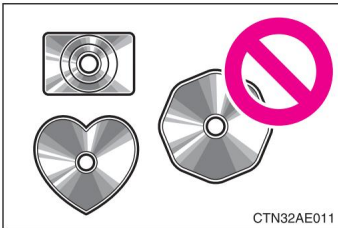
Using an 8cm CD adapter or a tray other than a genuine Toyota product may cause the CD autochanger to malfunction. For the Toyota genuine 8cm CD tray, please consult your Toyota dealer.



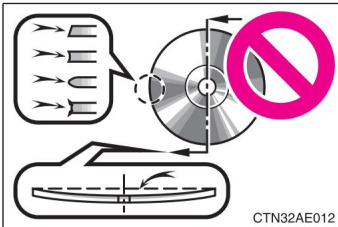
caution

⚠ Unusable CDs and adapters

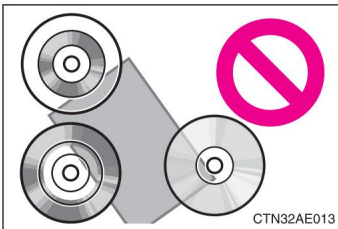
Do not use the following CDs, 8cm CD adapters, or Dual Discs. Doing so may damage the player or prevent the CD from being ejected.



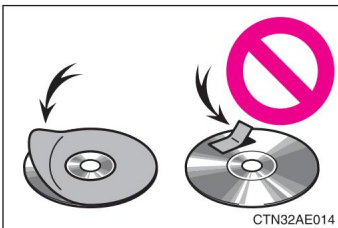
- Non-circular CDs with a diameter of 12 cm or 8 cm



A low-quality or deformed CD



CDs with a transparent or translucent recording area



CDs with cellophane tape, stickers, CD-R labels, etc., or CDs that have been peeled off



caution

Handling the CD player

If you do not observe the following, you may not be able to listen to the CD or the CD player may not work properly.

- Do not insert anything other than a CD into the CD slot.

Do not oil the CD player

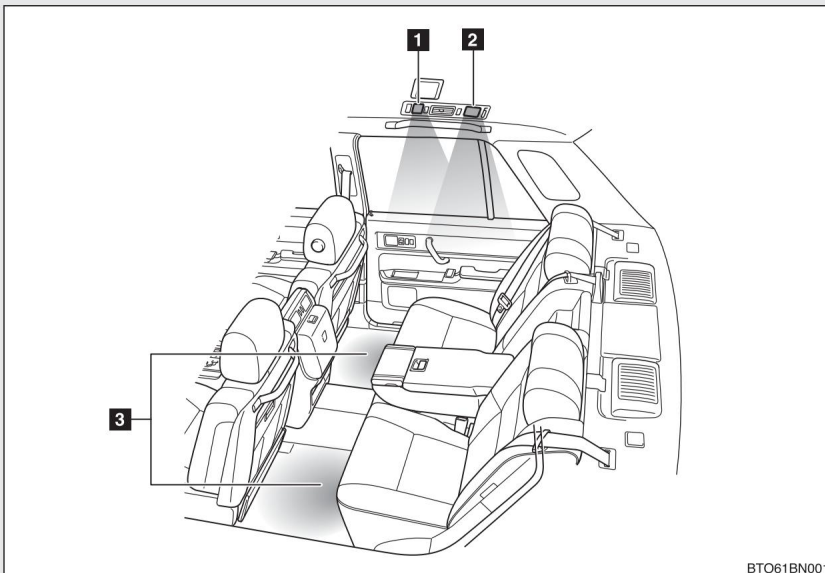
-Keep CDs out of direct sunlight

Do not disassemble the CD player

Do not use deformed discs

light List of interior lights

It has an illuminated entry system to aid in boarding and disembarking at night. Depending on whether the door is unlocked/locked, the door is opened/closed, or the position of the engine switch, the lighting of each part will turn on/off/dim.



BTO61BN001

- 1** Indoor
- 2** light Angle-adjustable reading
- 3** light Foot lighting



knowledge

• Functions that can be set at the store

You can change settings such as the time until the interior light turns off.

(List of customization functions P. 96)

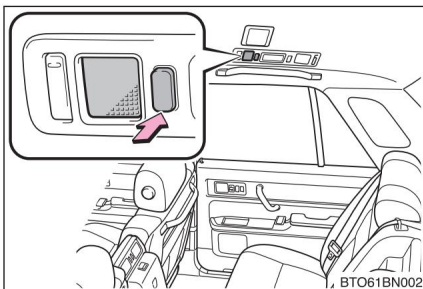


caution

• To prevent dead battery

Do not leave the light on for a long time with the engine stopped.

interior light



turn on turn off



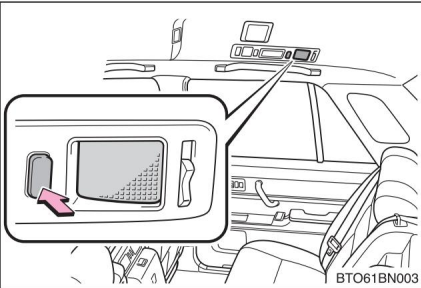
knowledge

• About interior lights

When the door is opened and the light is on, it cannot be turned off by the switch.

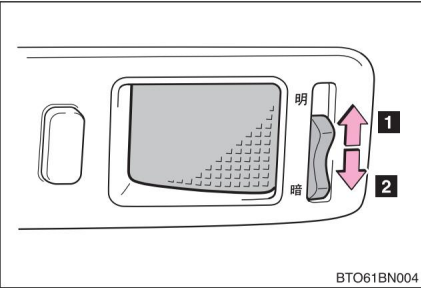
angle adjustable reading light

Lighting/turning off



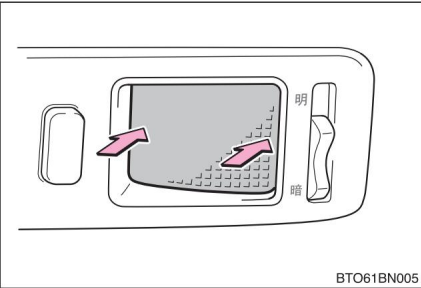
turn on turn off

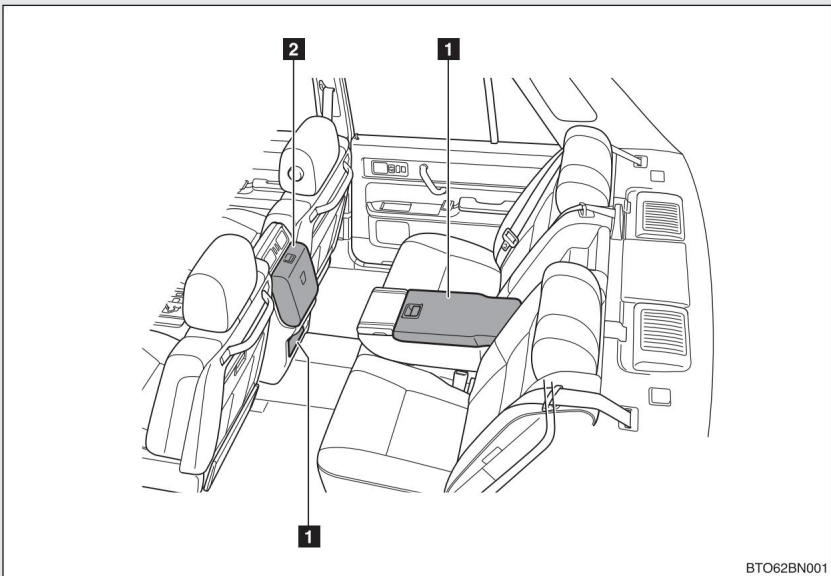
Adjust brightness



- 1 Ming
- 2 dark

Adjust the angle



3-4. How to use **storage****equipment List of storage equipment**

1 Accessory

2 compartment Cup holder*

*: Depending on the specifications, the cup holder may be installed in the rear center armrest.

There is also



warning

• Items that should not be left in storage equipment

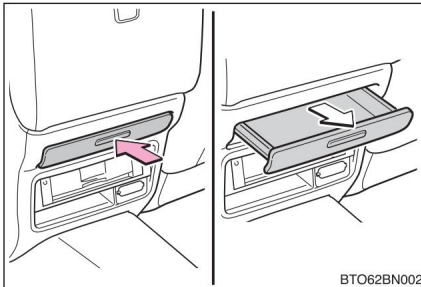
Do not leave eyeglasses, lighters or spray cans unattended in storage equipment. If left unattended, the following things may occur and are dangerous.

- Glasses may be deformed due to heat when the room temperature rises or contact with other stored items.
cause cracks

A lighter or spray can explodes when the room temperature rises, or the lighter ignites when it comes in contact with other stored items, or gas leaks from the spray can, leading to a fire.

accessory case

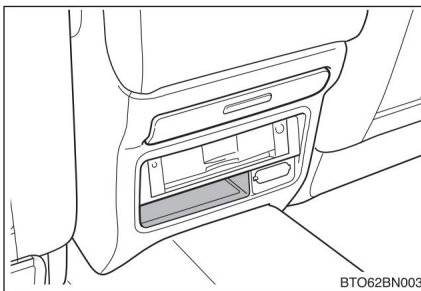
Upper glove compartment



press the lid

You can remove the accessory case
by pulling it out from the front position.

lower glove compartment



warning

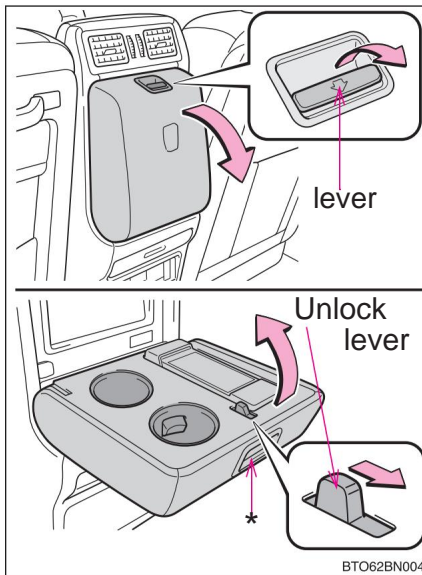
⚠ Warning while driving

Be sure to close the upper glove compartment. During sudden braking, etc., the opened console box may hit the body or the stored items may fly out, which may lead to an unexpected accident, which is dangerous.

cup holder

cup holder

Car with console tower cup holder



Pull the lever and push it forward

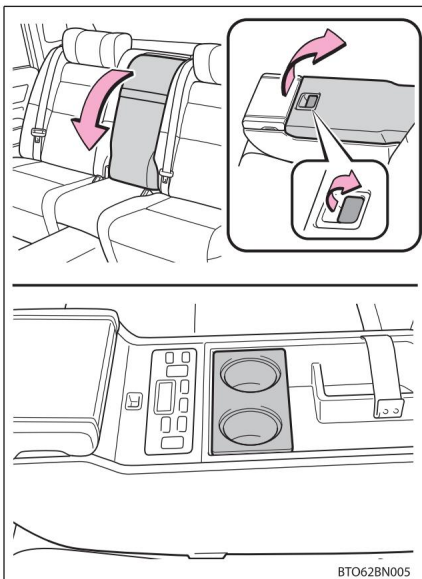
Push down until you hear a "click" to secure it in place.

When storing, lift the lock release lever while pulling it toward you.

The lock can also be released by pulling the * lever.

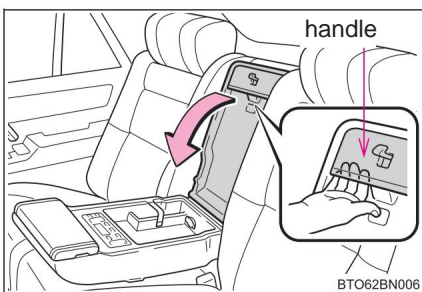
Car with center armrest cup holder

Open the lid



Fold down the rear center armrest and pull the lever to raise the cover.

Close the lid



Put your hand on the handle and pull the lid forward.

cup holder



warning

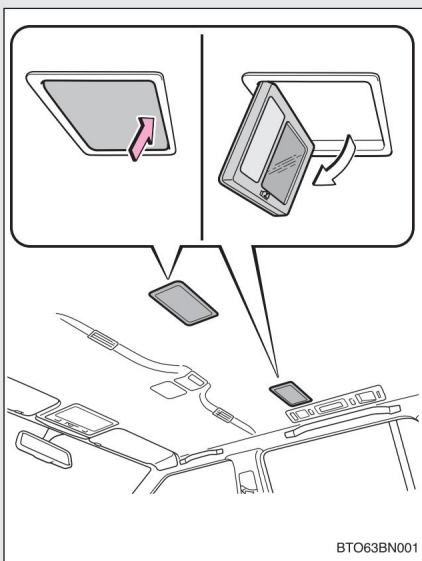
• Items that should not be stored

Do not place anything other than cups or cans in the cup holder. Sudden braking or an accident may cause the product to fall and cause injury. Keep hot drinks covered to prevent burns.

• When not in use

For vehicles equipped with console tower cup holders, be sure to store the cup holders. Be sure to close the lid on vehicles equipped with a cup holder on the center armrest. During sudden braking, for example, your body may hit the open lid, which may result in an unexpected injury, which is dangerous.

3-5. How to use other interior equipment **vanity mirror**



push the cover open

The light turns on when the cover is opened
increase.

The angle of the mirror can be adjusted
between approximately 90° and 132°.



warning

ÿ About the vanity mirror

Do not get on or off with the lid open. It is dangerous as it may cause unexpected injury such as bumping your head.



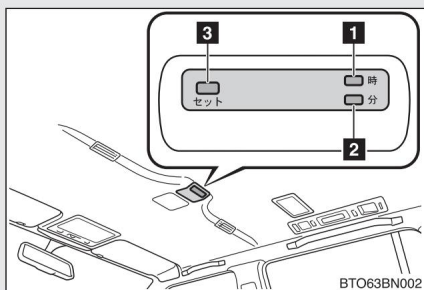
caution

ÿ To prevent dead battery

Do not leave the lights on for a long time with the engine stopped.

3-5. How to use other room equipment

Clock



- 1** “ adjust the hour
- 2** “ Adjust " Minute "
- 3** “ Set " Minute " to 00*
* (Example) 1:00 to 1:291:00
1:30 ÷ 1:592:00



knowledge

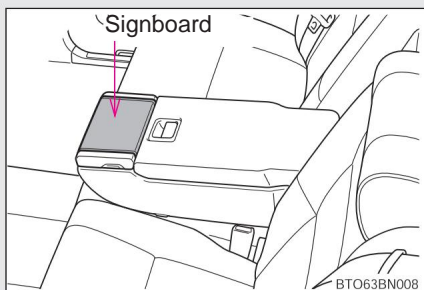
• When the time is displayed

When the engine switch is "ACC" or "ON"

• When connecting or disconnecting the battery terminals

The clock data is reset when the battery terminals are attached or detached.

3-5. How to use other interior equipment **sign board**



Fold down the rear center armrest

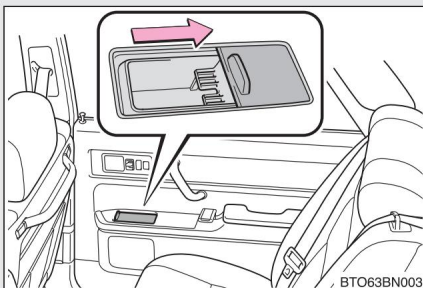


caution

• About the sign board

Using a pen with a sharp point may scratch the surface.

Ashtray



Open the lid by pulling it forward

When removing, hold the ashtray body and remove.



warning

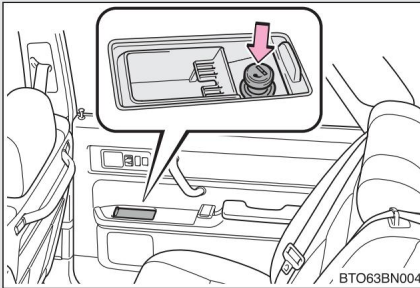
• After use

Be sure to close the lid. There is a risk of injury due to an unexpected accident or sudden stop while driving.

• To prevent fires

- Completely extinguish matches, cigarettes, etc. before placing them in the ashtray and securely close it. please.
- Do not put flammable items such as waste paper in the ashtray.

3-5. How to use other indoor equipment **Cigarette lighter**



Pull the lid forward to open it and push in the cigarette lighter.

It can be used once it returns to its original position.

increase.



knowledge

Conditions of use

When the engine switch is "ACC" or "ON"



warning

To prevent burns

- Do not touch the metal part of the cigarette lighter.
- Do not hold down the cigarette lighter.
- Do not plug into the power socket of any electrical product other than genuine Toyota products.
The socket may be deformed, and when the cigarette lighter is used later, the cigarette lighter may pop out or may not come out while being pushed in.

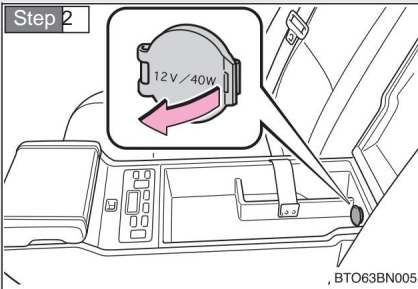
After use

Be sure to close the lid. There is a risk of injury due to an unexpected accident or sudden stop while driving.

3-5. How to use other interior equipment **Accessory sockets**

Use it as a power supply for electrical products with 12V 3.3A or less (maximum power consumption 40W).

Step 1 Open the lid behind the rear center armrest (ÿ P. 40)



Open the lid by pulling it forward



knowledge

ÿConditions of use

When the engine switch is "ACC" or "ON"



caution

ÿ To prevent short circuits and failures

Keep the lid closed when not in use to prevent foreign objects from entering the socket or splashing drinking water on it.

ÿ To prevent the fuse from blowing

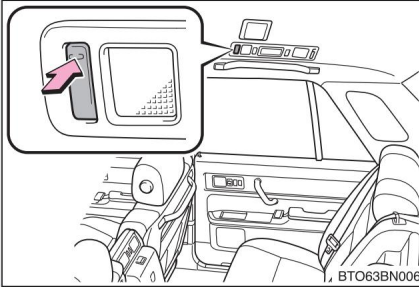
Make sure that the total of front and rear at 12V does not exceed 3.3A (maximum power consumption 40W).

ÿ To prevent dead battery

Do not use the accessory socket for a long time with the engine stopped.

3-5. How to use other indoor

equipment **Retractable coat hook**



push the tip of the hook



warning

Items that should not be hung on coat hooks

Do not hang hangers or other hard or sharp objects.

When the SRS curtain shield airbag is inflated, these objects may fly and cause serious injury or death.



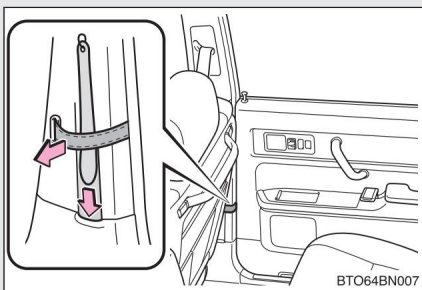
caution

To prevent damage

Do not overload the coat hook.

Shoehorn holder

Shoehorn can be stored.



Pull the belt and insert the shoehorn



knowledge

• About shoehorn storage

Depending on the size and shape of the shoehorn, it may not be possible to store it.

Maintenance method 4

4-1. How to maintain the
interior Care of the interior 92

4-1. How to care

Caring for the interior

Please follow the steps below for maintenance.

• Indoor care

Remove dust with a vacuum cleaner, etc., and wipe with a cloth moistened with water or lukewarm water.

• Maintenance of synthetic leather parts

- Use a vacuum cleaner to remove rough dirt
- Use a sponge or soft cloth to soften the synthetic leather part.
add detergent
- After leaving it for several minutes, remove the dirt, and then wipe off the detergent with a clean cloth that has been tightly wrung out.

• Cleaning the genuine leather

- Remove dust and sand with a vacuum cleaner, etc.
- Moisten a soft cloth with diluted detergent and wipe off the dirt.

Use a neutral wool detergent diluted to approximately 5% in water.

- Firmly squeeze a cloth soaked in fresh water to wipe off any detergent left on the surface.
- Wipe off moisture from the surface with a dry, soft cloth and dry in a well-ventilated shade.



knowledge

• Guidelines for cleaning genuine leather parts

In order to maintain the quality for a long time, we recommend regular maintenance about twice a year.

• Carpet cleaning

We recommend keeping the carpet as dry as possible. A commercially available foam type cleaner can be used for cleaning. Use a sponge or brush to spread the suds onto the carpet and work in circular motions. Do not pour water directly on it, wipe it off before drying.

• Seat belt

Clean with a mild detergent and warm water using a cloth or sponge. Regularly check the seat belt for wear, fraying, scratches, etc. (P.42)



warning

• Water intrusion into vehicles

- Do not pour water or spill liquids inside the vehicle. water on electrical parts
This is dangerous as it may lead to malfunction or vehicle fire.
- Do not get the components and wires of the SRS airbag wet. (P. 47) An electrical fault can cause the airbag to deploy or malfunction, resulting in death or serious injury.



caution

• Solvents used for cleaning

- Do not use organic solvents such as benzine or gasoline, acidic or alkaline solvents, dyes, or bleaches, as they may cause discoloration, stains, or paint peeling.
- Do not use polishing wax or polishing cleaner. It may cause peeling, dissolution, or deformation of the paint on the panel or other parts of the interior.

4-1. How to care



caution

• To avoid damage to the leather

To avoid damage and wear to the leather parts, please observe the following:

Immediately remove dust and sand from the leather

- Do not expose to direct sunlight for a long time. Keep your car in the shade, especially in the summer

Items made of vinyl, plastic, or that contain wax may damage the leather if the inside of the vehicle becomes hot.

Do not place on leather upholstery as it may stick to

• When water splashes on the floor

Do not wash with water. If water

splashes on the audio system or electric parts under the floor carpet, it may cause the car to malfunction or cause the body to rust.

• When cleaning the inside of the rear window glass

- Do not use glass cleaner, etc., as it may damage the heating wire and antenna. Wipe gently along the heating wire and antenna with a cloth moistened with water or lukewarm water.

- Be careful not to scratch or damage the heating wire or antenna.

• About the interior interior

Be careful not to scratch it with rings, watches, etc.

Customization 5

5-1 Customization function

Customization	
function list.....	96

5-1 Customization

function Customization function list

Your car has a number of features that you can change settings for. Operation and other settings can be changed at your Toyota dealer.

Depending on the function, some settings may change in conjunction with other functions. For details, please contact your Toyota dealer.

item	Function content	Initial setting	After change
Door lock (P. 14)	Vehicle speed sensitive door lock	can be	none
			Only the rear doors are automatically locked when the vehicle speed reaches approximately 20km/h or more.
illumination (P.74)	time until lights out	15 seconds	7.5 seconds
			30 seconds
			OFF
	Operation after engine switch "LOCK "	can be	none
	Operation when unlocking	can be	none
	Turning on foot lighting	can be	none

Sakuin



Japanese syllabary order 98

Japanese syllabary order

ah	Armrest 40
	Accessory sockets 87
stomach	illuminated entry
	System 74
corner	Window lock switch 19
e	Airbag
	SRS airbags 47
	General Warnings..... 51
	Note for children..... 51
	For curtain shield airbags
	warnings 52
	curtain shield airbag
	Operating conditions 48
	Modification/Disassembly 53
	for side airbags
	warnings 52
	side air bag
	Operating conditions 48
	Correct Posture 46
	Placement 47
	Air Conditioner 56
	air purifier
	(air purifier) 58
oh	audio
	Listening to the radio..... 65
	front seat audio
	Listening to Cassette Tapes.....67
	Listening to CDs 69
	Ottoman 31
neck	Curtain shield airbags.....47
	Customized functions96
	Angle-adjustable reading light76
	Retractable coat hook88
	Cup holder79
nine	Air cleaner
	(air purifier).....58
	Shoehorn holder.....89
child	Operation of the front passenger seat from the rear seat
	part of the backrest
	Push it backwards.....31
	Adjusting the fore-and-aft position28
	Retracting the head restraint31
	Reclining adjustment28
	front from back seat
	Operating the air conditioner56
	Accessory box78
	Comfortable air seat
36
reference	Side airbags47
	Signboard84

death	sheet	When	door
	Comfortable air seat		Door glass19
 36		Door lock14
	Heated seats 34		Door open interlocking return operation function26
	Correct Posture 46		Reading light 76
	Adjustment 22		clock83
	Care..... 92	teeth	Ashtray85
	Headrest 23		Vanity mirrors.....82
	Seat position memory and		Power windows19
	Call function..... 24	debt	Filters37
	Seat heaters 34		Footrest30
	Seat belt	What	headrest
	emergency seat belt		How to fold down the front passenger seat headrest ...31
	Locking Mechanism 43		of the headrest
	Seat belt		Adjusting the vertical position22
	Pretensioner 44		of the headrest
	Cleaning and Maintenance..... 93		Adjusting the fore-and-aft position22
	Proper wearing 42	fruit	mirror
	Wearing by pregnant women 43		Vanity mirror.....82
	Cigarette Lighter 86	devil	Negative ion generator.....62
	Interior light 75	refresh sheet
height	cleaning		(seat with vibrator)38
	Seat belts 93		Rear air conditioner56
	Interior 92	Ru	Room light75
hand	Care		
	Seat belts 93		
	Interior 92		

Century for rear seats

C-28



Please contact the following
for inquiries and consultations.

Toyota Motor Corporation Customer Service
Center Nationwide Toll Free Call

 **0800-700-7700**

Open hours 9:00-18:00, 365 days a year

Location 〒450-0002 4-10-27 Meieki, Nakamura-ku,
Nagoya City Daini Toyota

Bldg . .

トヨタ自動車株式会社
<http://toyota.jp>

•Please note that the contents of this manual may not match the vehicle due to changes in vehicle specifications. •Print IB-November 21, 2012 •Issue-August 23, 2010 1st edition •November 28, 2012 2nd edition

M 40435
01999-- 40435